

Stored pressure

Water

9 L

Temperature ranges

+5°C + 60°C



On request



21

BODY

ALUMINUM

Seamless, deep and drawn aluminum alloy body, ensures maximum sealing and, thanks to its light weight, perfect handling. Plastic foot ring prevents ground contact. Externally painted with polyester resin

VALVE

ACETALYC RESIN

Squeeze grip lever operated valve with acetal resin body, ensuring perfect protection against corrosion. The shock-proof pressure gauge is equipped with a non-return valve to allow pressure control and with a sintered filter to protect sensitive parts

HOSE

The EPDM reinforced rubber hose guarantees perfect flexibility and resistance within the temperature range. Complete with nozzle

EXTINGUISHING AGENT

Pure water

PROPELLANT

The propellant gas is nitrogen. A small percentage of helium is added to allow electronic leak detection

STANDARD PACKAGING

Single piece cardboard box, robust and suitable for transport



WEIGHT Kg 11,96

DIMENSION mm 180 Ø x 625

Accessories

● Standard ○ On request

BRACKET



● Button holed wall bracket



○ Back hook wall bracket kit



○ Transport bracket

HOSE RINGS & PROTECTIVE BASE



● Protective base 180 mm



● Screw hose clip



○ Hose holder 180mm

ADDITIONAL FEATURES



● One color screen printing



○ Two-color PVC label

PACKAGING



● One-piece havana cardboard box

Technical data

FIRE CLASSES	21A	
CHARGE	9 l +0 / -5%	
CYLINDER	Manufacturing process	Deep drawing
	External painting	Polyester resin, minimum thickness 50 micron
	Corrosion resistance	480 h minimum according to ISO 9227:2017
HOSE	Reinforced rubber tube with nozzle	
	Overall length	705 mm
EXTINGUISHING AGENT	Water + additives	
PROPELLANT	Nitrogen or nitrogen + helium	
DISCHARGE	Discharge time	~ 52 s
PRESSURE	Operating pressure at 20 °C	11 bar
	Operating pressure at 60 °C	13 bar
	Operating pressure at 0 °C	9 bar
DIMENSIONS	Overall height	620 mm
	Bottle outer diameter	180 mm
WEIGHT	Empty / Charged	2,96 kg / 11,96 kg
PACKAGING SPECIFICATIONS	Standard packing	Single piece cardboard box
	Carton size (B x L x H)	195 x 195 x 650 mm
	Weight per carton	12,50 kg
	Pallet	48 cartons
	Pallet size (B x L x H)	800 x 1200 x 1440 mm
	Pallet volume	1,38 m ³
	Weight per pallet (net/gross)	600 kg / 620 kg

© REPRODUCTION IS FORBIDDEN

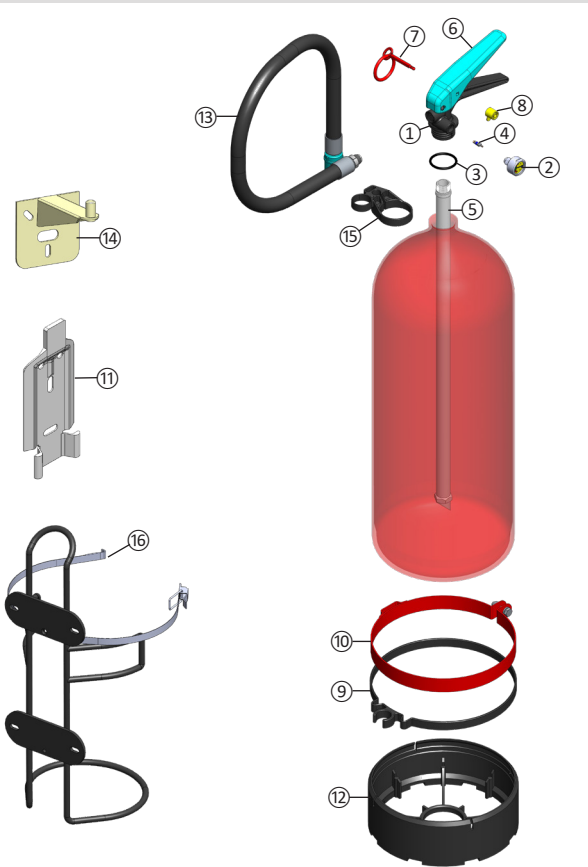

Nr.	Description	Code
1	Valve with blue lever and o-ring, without gauge and safety pin	00.860E.8505.00
2	Pressure gauge	00.814E.4950.20
3	O-ring for the valve	00.033E.1100.01
4	Schrader Valve	00.600A.5100.00
5	Dip tube	00.850F.5900.00
6	Blue lever	00.850E.5100.20
7	Safety pin	00.850E.5300.00
8	Green seal	00.652A.5030.VE
9	Hose holder Ø180	00.800F.2800.00
10	Metallic support Ø 160	00.850F.2970.00
11	Wall bracket	00.005E.2950.00
12	Protective base Ø 180	00.030E.7120.00
13	Complete hose	00.860F.2400.05
14	Button holed wall bracket	00.005E.2900.00
15	Screw hose clip	00.850E.2955.20
16	Transport bracket	00.814F.2900.00

08.860F.00.09.2021

ANAFGROUP

Via del Commercio, 4 - Torre d'Isola (Pavia)
 Tel. 0382.4533 Fax. 0382.920279
 info@anaf.eu | www.anaf.eu

