

Stored
pressure

Powder

9 kg

Temperature ranges

-30°C + 60°C



On request

BODY

STEEL

Deep drawn 2-pieces mild steel cylinder, wire feed welded. Externally painted with polyester resin

VALVE

ALUMINUM

Squeeze grip lever operated valve with aluminum body. The shock-proof pressure gauge provides an accurate indication of the pressure status of the extinguisher

HOSE

The EPDM reinforced rubber hose guarantees perfect flexibility and resistance within the temperature range. Complete with nozzle

EXTINGUISHING AGENT

Two types of ABC extinguishing agents, certified according to EN 615:

- ABC multi-purpose dry powder
- TOP: with new additives and different granulometry, thus ensuring higher performances

PROPELLANT

The propellant gas is nitrogen. A small percentage of helium is added, to allow electronic leak detection

STANDARD PACKAGING

Single piece cardboard box, robust and suitable for transport



PS9-HH ABC



PS9-HH TOP



WEIGHT
Kg

12,50

DIMENSION
mm

190 Ø x 545

Accessories

- Standard
- On request

BRACKET



● Button holed wall bracket

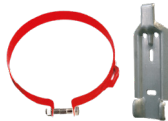

○ Hook wall bracket kit



○ Transport bracket



○ Welded back hook

HOSE RINGS & PROTECTIVE BASE



● Hose holder 190mm



○ Protective base 190 mm

ADDITIONAL FEATURES



● One color screen printing



○ Two-color PVC label



○ Safety Valve HHZ

PACKAGING



● One-piece havana cardboard box

Technical data

FIRE RATINGS	ABC powder	43A 233B C
	TOP powder	55A 233B C
CHARGE	9 kg \pm 2%	
CYLINDER	Manufacturing process	Deep drawing
	External painting	Polyester resin, minimum thickness 50 micron
	Corrosion resistance	480 h minimum according to ISO 9227:2017
EXTINGUISHING AGENT	ABC powder	ANAF - A32 ABC dry powder
	TOP powder	ANAF - TOP powder
PROPELLANT	Nitrogen or nitrogen + helium	
DISCHARGE	Discharge time	~ 21 s
PRESSURE	Operating pressure at 20 °C	13 bar
	Operating pressure at 60 °C	15 bar
	Operating pressure at -30 °C	11 bar
DIMENSIONS	Overall height	545 mm
	Bottle outer diameter	190 mm
WEIGHT	Empty / Charged	3,84 kg / 12,84 kg
PACKING SPECIFICATIONS	Standard packing	Single pieces cardboard box
	Carton size (B x L x H)	200 x 200 x 600 mm
	Weight per carton	13,40 kg
	Pallet	48 cartons
	Pallet size (B x L x H)	800 x 1200 x 1500mm
	Pallet volume	1,44 m ³
	Weight per pallet (net/gross)	643 kg / 663 kg

© REPRODUCTION IS FORBIDDEN

32.895F.01.09.2021

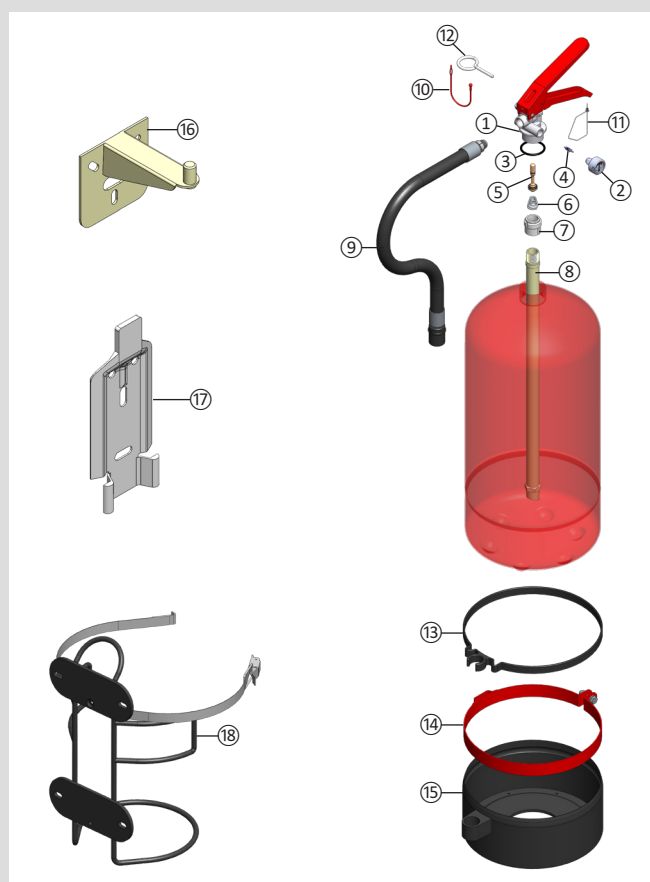

Nr.	Description	Code
1	Complete valve withou pressure gauge	00.886E.8100.01
2	Pressure gauge	00.245E.4951.10
3	O-ring for the valve	00.033E.1100.01
4	Schrader valve	00.886E.5100.00
5	Internal spindle with o-ring	00.241E.6100.00
6	Conical Spring	00.886E.5200.00
7	Dip tube holder	00.886E.5810.00
8	Dip tube	00.895F.5900.00
9	Assembled hose	00.890F.2400.05
10	Red lace holder for safety pin	00.886E.9290.00
11	Safety seal	00.005A.3220.00
12	Metal Safety pin	00.886E.5020.00
13	Hose holder Ø 190	00.895F.2800.00
14	Metallic support Ø 190	00.895F.2970.00
15	Plastic base Ø 190 with hose holder	00.265F.2100.01
16	Button holed wall bracket	00.005E.2900.00
17	Wall bracket	00.005E.2950.00
18	Transport Bracket	00.241F.2900.00

ANAFGROUP

Via del Commercio, 4 - Torre d'Isola (Pavia)
 Tel. 0382.4533 Fax. 0382.920279
 info@anaf.eu | www.anaf.eu