

Stored pressure

Foam

9 Lt

Temperature ranges

0°C + 60°C



On request



BODY

ALUMINUM

Seamless, deep drawn aluminum alloy body, ensures maximum sealing and, thanks to its light weight, perfect handling. Plastic foot ring prevents ground contact. Externally painted with polyester resin

VALVE

ALUMINUM

Squeeze grip lever operated valve with aluminum body. The shock-proof pressure gauge provides an accurate indication of the pressure status of the extinguisher

HOSE

The EPDM reinforced rubber hose guarantees perfect flexibility and resistance within the temperature range. Complete with nozzle

EXTINGUISHING AGENT

Water with additives (to improve class A) and AFFF. All parts in contact with the extinguishing agent are compatible

PROPELLANT

The propellant gas is nitrogen. A small percentage of helium is added, to allow electronic leak detection

STANDARD PACKAGING

Single piece cardboard box, robust and suitable for transport



WEIGHT Kg 12,30

DIMENSION mm 180 Ø x 625

Accessories

● Standard ○ On request

BRACKET



● Button holed wall bracket



○ Transport bracket



○ Back hook wall bracket kit

HOSE RINGS & PROTECTIVE BASE



● Hose holder 180mm



● Protective base 180 mm

ADDITIONAL FEATURES



● One color screen printing



○ Two-color PVC label



○ Safety Valve LHFZ

PACKAGING



● One-piece havana cardboard box

Technical data

FIRE CLASSES	34A 233B 75F	
CHARGE	9 l +0 / -5%	
CYLINDER	Manufacturing process	Deep drawing
	External painting	Polyester resin, minimum thickness 50 micron
	Corrosion resistance	480 h minimum according to ISO 9227:2017
HOSE	Reinforced rubber tube with nozzle	
	Overall length	705 mm
EXTINGUISHING AGENT	Water + additives	
PROPELLANT	Nitrogen or nitrogen + helium	
DISCHARGE	Discharge time	~ 46 s
PRESSURE	Operating pressure at 20 °C	11 bar
	Operating pressure at 60 °C	13 bar
	Operating pressure at a 0 °C	9 bar
DIMENSIONS	Overall weight	630 mm
	Bottle outer diameter	180 mm
WEIGHT	Empty / Charged	2,98 kg / 12,25 kg
PACKAGING SPECIFICATIONS	Standard packing	Single piece cardboard box
	Carton size (B x L x H)	195 x 195 x 650 mm
	Weight per carton	12,80 kg
	Pallet	48 cartons
	Pallet dimensions (B x L x H)	800 x 1200 x 1440 mm
	Pallet volume	1,38 m ³
	Weight per pallet (net/gross)	614,40 kg / 634,40 kg

© REPRODUCTION IS FORBIDDEN

09.896F.01.09.2021

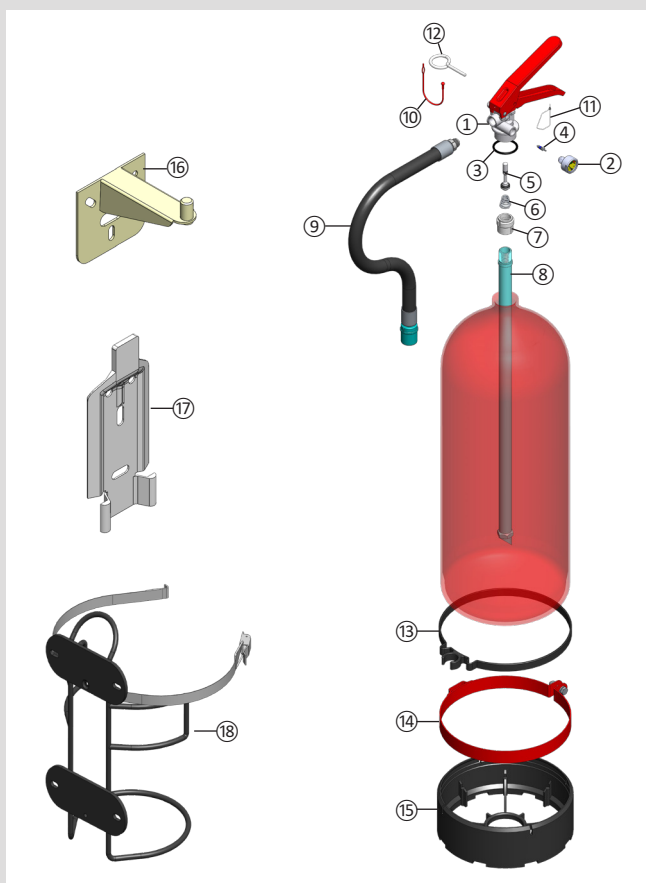

Nr.	Description	Code
1	Complete valve without pressure gauge	00.886E.8090.00
2	Pressure gauge	00.814E.4950.20
3	O-ring for the valve	00.033E.1100.01
4	Check valve type Schrader	00.886E.5100.00
5	Internal spindle with o-ring	00.886E.5030.00
6	Conical spring	00.886E.5200.00
7	Dip tube holder	00.886E.5810.00
8	Dip tube	00.886F.5900.00
9	Assembled hose	00.860F.2400.05
10	Red lace holder for safety pin	00.886E.6290.00
11	Safety seal	00.005A.3220.00
12	Metal safety pin	00.886E.5020.00
13	Hose holder Ø180	00.800F.2800.00
14	Metallic support Ø180	00.850F.2970.00
15	Plastic base Ø180 with hose holder	00.030E.7120.00
16	Button holed wall bracket	00.005E.2900.00
17	Wall bracket	00.005E.2950.00
18	Transport bracket	00.814F.2900.00

ANAFGROUP

Via del Commercio, 4 - Torre d'Isola (Pavia)
 Tel. 0382.4533 Fax. 0382.920279
 info@anaf.eu | www.anaf.eu