

**Stored  
pressure**

**Foam**

**9 Lt**

**Temperature ranges**

0°C + 60°C



On request



34



233

## BODY

ALUMINUM

Seamless, deep drawn aluminum alloy body, ensures maximum sealing and, thanks to its light weight, perfect handling. Plastic foot ring prevents ground contact. Externally painted with polyester resin

## VALVE

ACETALYC RESIN

Squeeze grip lever operated valve with acetal resin body, ensuring perfect protection against corrosion. The shock-proof pressure gauge is equipped with a non-return valve to allow pressure control and with a sintered filter to protect sensitive parts

## HOSE

The EPDM reinforced rubber hose guarantees perfect flexibility and resistance within the temperature range. Complete with nozzle

## EXTINGUISHING AGENT

Water with fire retardant and AFFF. All parts in contact with the extinguishing agent are protected against corrosion

## PROPELLANT

The propellant gas is nitrogen. A small percentage of helium is added, to allow electronic leak detection

## STANDARD PACKAGING

Single piece cardboard box, robust and suitable for transport



**WEIGHT  
Kg**

12,23

**DIMENSION  
mm**

180 Ø x 615

## Accessories

● Standard ○ On request

### BRACKET

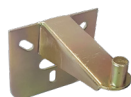

● Button holed wall bracket



○ Transport bracket



○ Back hook wall bracket kit

### HOSE RINGS & PROTECTIVE BASE



● Screw hose clip



● Protective base 180 mm

### ADDITIONAL FEATURES



● One color screen printing



○ Two-color PVC label

### PACKAGING



● One-piece havana cardboard box

# Technical data

FIRE CLASSES	34A 233B	
CHARGE	9 l +0 / -5%	
CYLINDER	Manufacturing process	Deep drawing
	External painting	Polyester resin, minimum thickness 50 micron
	Corrosion resistance	480 h minimum according to ISO 9227:2017
HOSE	Reinforced rubber tube with nozzle	
	Overall lenght	705 mm
EXTINGUISHING AGENT	Water + additives	
PROPELLANT	Nitrogen or nitrogen + helium	
DISCHARGE	Discharge time	~ 46 s
PRESSURE	Operating pressure at 20 °C	11 bar
	Operating pressure at 60 °C	13 bar
	Operating pressure at 0 °C	9 bar
DIMENSIONS	Overall height	620 mm
	Bottle outer diameter	180 mm
WEIGHT	Empty / Charged	2,96 kg / 12,23 kg
PACKAGING SPECIFICATIONS	Standard packing	Single piece cardboard box
	Carton size (B x L x H)	195 x 195 x 650 mm
	Weight per carton	12,77 kg
	Pallet	48 cartons
	Pallet size (B x L x H)	800 x 1200 x 1440 mm
	Pallet volume	1,38 m <sup>3</sup>
	Weight per pallet (net/gross)	613 kg / 633 kg

© REPRODUCTION IS FORBIDDEN

09.860F.00.08.2021

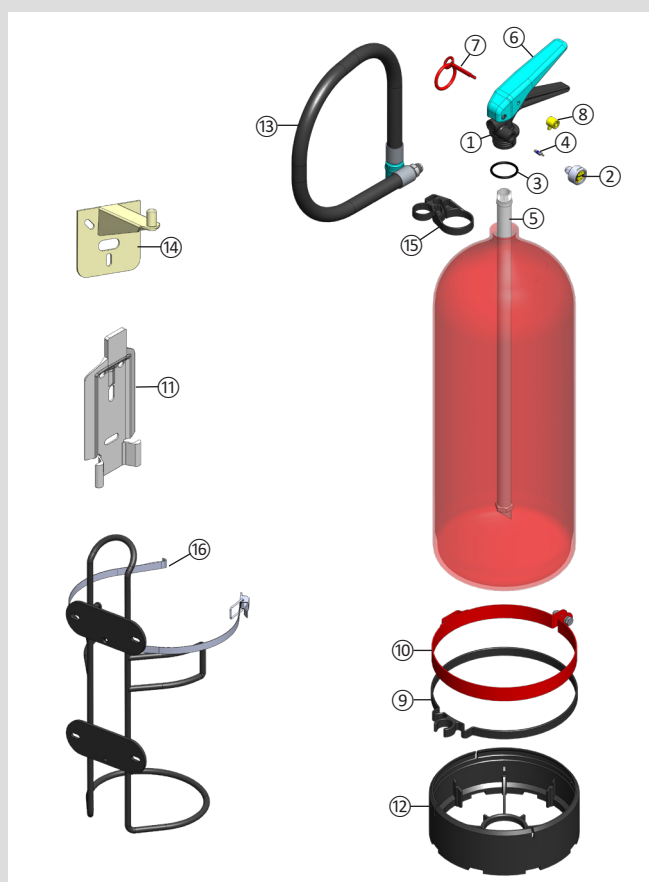

Nr.	Description	Code
1	Valve with blue lever and o-ring, without gauge and safety pin	00.860E.8505.00
2	Pressure gauge	00.814E.4950.20
3	O-ring for the valve	00.033E.1100.01
4	Schrader Valve	00.600A.5100.00
5	Dip tube	00.850F.5900.00
6	Blue lever	00.850E.5100.20
7	Safety pin	00.850E.5300.00
8	Green seal	00.652A.5030.VE
9	Hose holder Ø180	00.800F.2800.00
10	Metallic support Ø 190	00.850F.2970.00
11	Wall bracket	00.005E.2950.00
12	Protective base Ø 180	00.030E.7120.00
13	Complete hose	00.860F.2400.05
14	Button holed wall bracket	00.005E.2900.00
15	Screw hose clip	00.850E.2955.20
16	Transport bracket	00.814F.2900.00

# ANAFGROUP

Via del Commercio, 4 - Torre d'Isola (Pavia)  
 Tel. 0382.4533 Fax. 0382.920279  
 info@anaf.eu | www.anaf.eu